

SMA STRAIGHT CRIMP / CRIMP PLUG 30-045-N3-AE

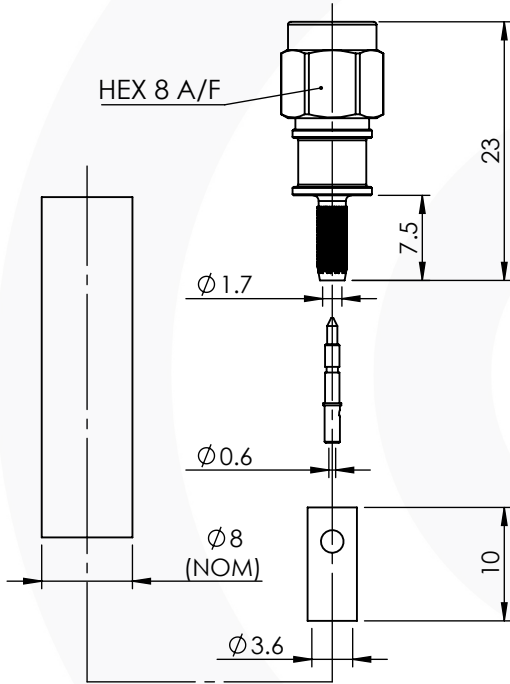

images for illustration purposes only



RECOMMENDED COUPLING NUT TORQUE: 0.8 - 1.13 Nm

| ITEM | DESCRIPTION | MATERIAL | PLATING |
|------|----------------|-----------------|------------|
| 7 | COUPLING NUT | STAINLESS STEEL | PASSIVATED |
| 6 | HEATSHRINK | POLYOLEFIN | N/A |
| 5 | GASKET | SILICONE | N/A |
| 4 | CRIMP SLEEVE | BRASS | GOLD |
| 3 | INSULATOR | PTFE | N/A |
| 2 | CENTRE CONTACT | BRASS | GOLD |
| 1 | BODY | STAINLESS STEEL | GOLD |

| | | | | |
|------------|--------------|-------------------------------|-----------|----------|
| A4 | SHEET 1 OF 1 | DIMENSIONS ARE IN MILLIMETRES | | |
| REVISION : | A01 | NAME | SIGNATURE | DATE |
| ISSUE : | 1 | DRAWN | G.E. | 09/11/17 |
| | | CHK'D | I.G. | 09/11/17 |
| | | APPV'D | | |

6-8 COLNE ROAD,
TWICKENHAM,
MIDDLESEX.
TW1 4JR

THE INFORMATION IS GIVEN AS AN INDICATION ONLY AND IS SUBJECT TO CHANGE WITHOUT NOTICE. IN THE CONTINUAL GOAL TO IMPROVE OUR PRODUCTS, WE RESERVE THE RIGHT TO MAKE ANY MODIFICATIONS NECESSARY WITHOUT PRIOR NOTICE.

Suitable for Cables:

(AE) RD316, RD188

Stripping Dimensions

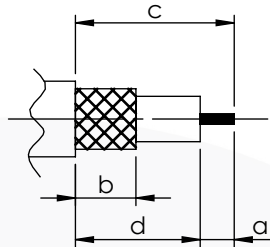

a = 3.0 mm
b = 8.0 mm
c = 16.0 mm
d = 13.0 mm

Assembly Procedure: AP001

Tooling

Centre Contact: Indent or SQ 1.07mm A/F Tool No: 336J

Crimp Sleeve: HEX 3.84mm A/F Tool No: 336J

Alignment Tool: Not Applicable Extraction: Not Applicable

Environmental Specification

Operating Temp: -55 to +110 Deg C.

IP Rating (Mated): IP 68

Electrical Specification

Impedance: 50 Ohm

Frequency: 0-12 GHz

Dielectric W/V: 750 Veff

Insulation res: 5000 M-Ohm

Mechanical Specification

Contact Retention: 27 N min

Cable Retention: 150 N min

Mating cycles: 500

Weight: 4.39 g

Connector Interface

image for illustration purposes only

