

Assembly Procedure

WEBSITE
VIDEO No.

- Slide crimp sleeve onto cable
- Strip cable
- Slide centre contact onto cable conductor up to cable dielectric
- Ensure that the conductor is visible through the Contact inspection hole.
- Crimp the centre contact using appropriate sized crimping tool
- Fan the braid out
- Slide the cable into the connector and push home until the centre contact "CLICKS" into place
- Slide the crimp sleeve over the braid
- Crimp the crimp sleeve using the appropriate sized crimp tool (trim excess braid if necessary)



Electrical Specification

Impedance: 75 Ohm
 Frequency: 0 - 2 GHz
 Dielectric W/V: 1000 V rms max
 Insulation res: 1000 M-Ohm min

Mechanical Specification

Centre contact retention
 Axial Force: 10N
 Cable Retention: 220N
 Mating cycles: 500

Environmental Specification

Operating Temp: -45 to +85 Deg C

Tooling

Centre Contact: SQ 1.07 mm A/F
 COAX Tool No: 336G1
 Crimp Sleeve: HEX 5.41 mm A/F
 COAX Tool No: 336G1



DO NOT SCALE DRAWING



DATA SHEET

SHEET 1 OF 1

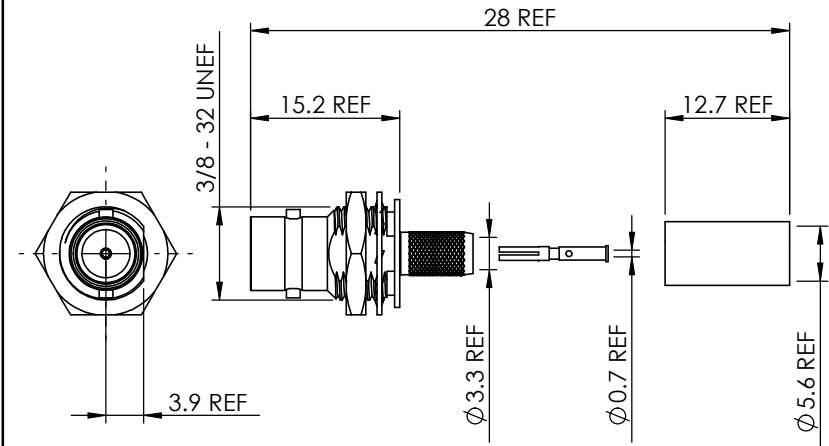

STRIPPING DIMENSIONS

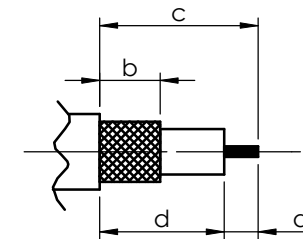

a = 4.0 mm
 b = 8.0 mm
 c = 16.0 mm
 d = 12.0 mm



COAX CONNECTORS LTD
 6-8 COLNE ROAD, TWICKENHAM,
 MIDDLESEX. TW1 4JR

Description

75 Ohm MINI BNC B/H
 SOCKET IMAGE 360

Part Number

63-254-B6-FA

REVISION : A00

A4

DIMENSIONS ARE IN MILLIMETERS

NAME	SIGNATURE	DATE
DRAWN	GE	15/02/2010
CHK'D	IG	15/02/2010
APPV'D		

THE INFORMATION IS GIVEN AS AN INDICATION ONLY AND IS SUBJECT TO CHANGE WITHOUT NOTICE. IN THE CONTINUAL GOAL TO IMPROVE OUR PRODUCTS, WE RESERVE THE RIGHT TO MAKE ANY MODIFICATIONS NECESSARY WITHOUT PRIOR NOTICE.

7			
6	RETAINER	BRASS	NICKEL
5	NUT	BRASS	NICKEL
4	LOCK WASHER	STEEL	NICKEL
3	INSULATOR	PTFE	N/A
2	CENTRE CONTACT	BeCu	GOLD
1	BODY	BRASS	NICKEL
ITEM	DESCRIPTION	MATERIAL	PLATING